



BE1SP
Llave para bujías





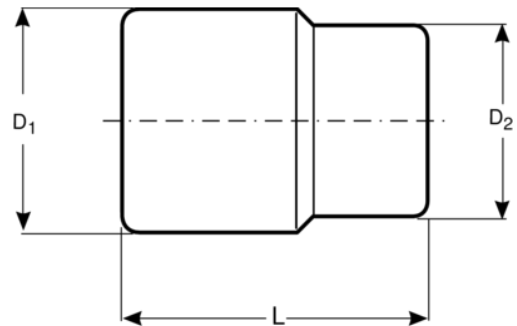

DETALLES DEL PRODUCTO

- Llaves para bujías utilizadas para instalar o extraer bujías de motores
- Sistema interno de retención de goma para sujetar la bujía
- Perfil bi-hexagonal, tamaños metrix
- Cuadradillo de 3/8"
- Acero de alto rendimiento
- Acabado plateado cromado mate



ATRIBUTOS DE PRODUCTO

Producto				L	D1	D2	
BE1SP16L	3/8 in	16 mm	5/8 in	252 mm	20,5 mm	20,5 mm	480 g
BE1SP14L	3/8 in	14 mm	9/16 in	252 mm	18 mm	18 mm	345 g

Follow the Fish!

